



CHROMOSOME DYNAMICS 2026

International Symposium on Chromosome Dynamics: from Structure to Cellular Function

31 May – 3 June 2026

Awaji Yumebutai

International Conference Center

Hyogo, Japan

Organizers:

Tatsuo Fukagawa (Univ. Osaka)

Toru Hirota (JFCR)

Daniele Fachinetti (Institut Curie)

Location

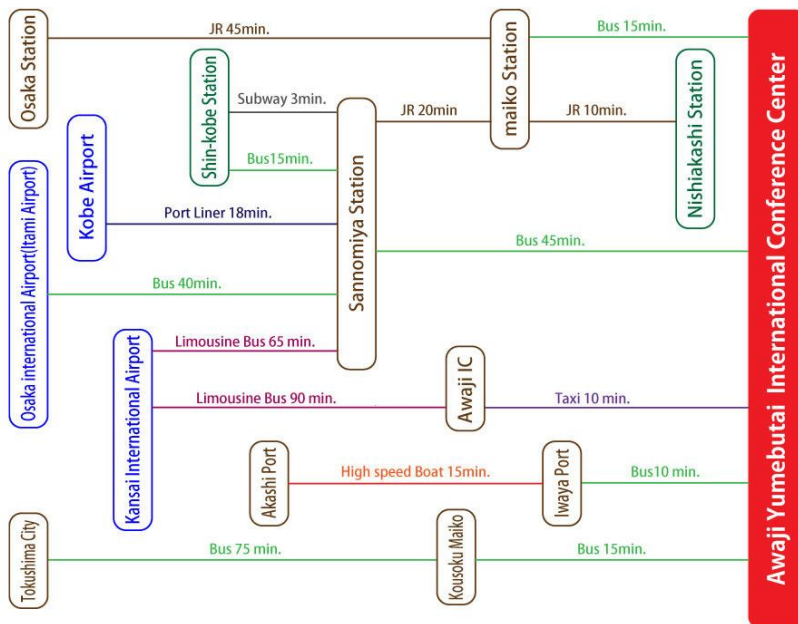
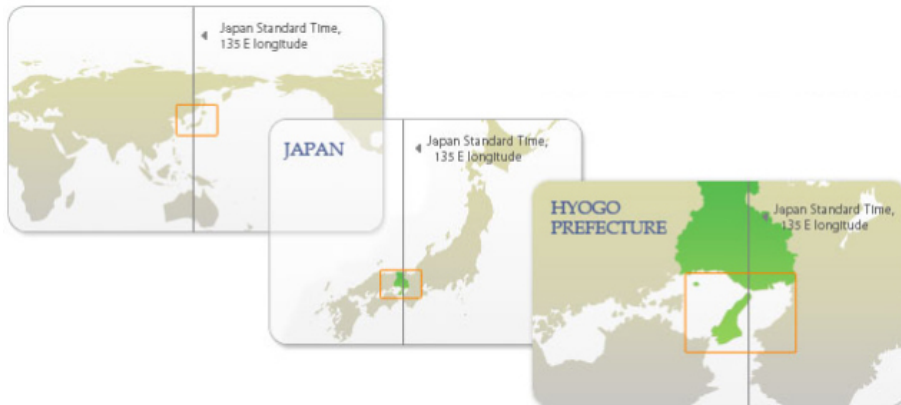

Major access

- Kansai Int'l airport
 - (Bus, 65min) – Sannomiya station
 - (Bus, 45 min) – Awaji Yumebutai
- Shin-kobe (Shinkansen station)
 - (subway, 3min) - Sannomiya station
 - (Bus, 45 min) – Awaji Yumebutai

From Kansai Int'l Airport to Yumetubtai via Sannomiya



BUS TIMETABLES Kansai Int'l Airport <--> Awaji Yumebutai (via Sannomiya)

as of Dec 20, 2025

- Available on weekends & national holidays only
- Available on weekdays only
- Available every day

Ticket Prices (One Way)

Airport Bus (Kansai Int'l Airport to/from Sannomiya): JPY 2,200
 Highway Bus (Sannomiya to/from Awaji Yumebutai): JPY 1,100

TO Awaji Yumebutai

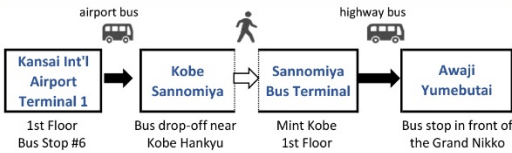

DEP.	ARR.	DEP.	ARR.
6:20	7:25	8:00	8:48
6:50	7:55		
7:10	8:15	8:30	9:18
7:40	8:45	8:55	9:48
8:00	9:05	9:30	10:18
8:20	9:25		
8:30	9:35		
8:40	9:45	10:00 <small>(bus stop #5)</small>	10:48
9:00	10:05	10:30	11:18
9:20	10:25		
9:40	10:45	11:00 <small>(bus stop #5)</small>	11:48
10:00	11:05		
10:10	11:15	11:30 <small>(bus stop #5 on weekends & holidays)</small>	12:15
10:20	11:25		
10:40	11:45	12:30	13:15
11:00	12:05		
11:20	12:25		
11:30	12:35		
11:40	12:45		
12:00	13:05	13:30	14:18
12:20	13:25		
12:40	13:55		
12:55	14:00		
13:10	14:15	14:30	15:15 15:18
13:25	14:30		
13:40	14:45		
14:00	15:05		
14:15	15:20	15:30	16:15 16:18
14:35	15:40	16:00	16:48
14:55	16:10	16:20	17:08
15:10	16:15		
15:25	16:30		
15:40	16:45	17:00	17:48
15:55	17:00		
16:15	17:20	17:30	18:18
16:35	17:40	17:50	18:38
		18:00	18:48
16:55	18:00		
17:15	18:20	18:30	19:18
17:35	18:40	19:00	19:45

The highway buses below stop at 'Kokudo Yumebutai', not the 'Awaji Yumebutai' bus stop.

DEP.	ARR.	DEP.	ARR.
17:50	19:05		
18:05	19:10		
18:15	19:20	19:30	20:15
18:35	19:40		
18:45	19:50	20:00	20:45
19:00	20:15		
19:10	20:15	20:30	21:15
19:30	20:35		
19:45	20:50	21:00	21:45
20:00	21:05		
20:15	21:30		
20:35	21:40	21:50	22:35
20:55	22:00		
21:15	22:20		
21:35	22:40	23:00	23:45

*Airport Bus departures after 21:35 are not listed in this schedule.

FROM Awaji Yumebutai

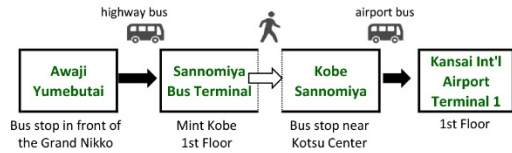

DEP.	ARR.	DEP.	ARR.
8:15	9:02	9:20	10:25
8:20	9:07	9:40	10:55
		10:00	11:05
8:55	9:42	10:20	11:25
9:15	10:02		
9:30	10:17		
9:35	10:22	10:40	11:45
9:45	10:32	10:50	11:55
9:55	10:42	11:00	12:05
10:15	11:02	11:20	12:25
10:35	11:22	11:40	12:55
10:45	11:32		
10:55	11:42	12:00	13:05
11:15	12:02	12:20	13:25
		12:40	13:45
11:45	12:32	13:00	14:05
		13:20	14:25
		13:40	14:45
12:50	13:37	14:00	15:05
		14:20	15:25
		14:40	15:45
13:45	14:32	15:00	16:05
14:20	15:07	15:20	16:25
		15:40	16:45
14:45	15:32	16:00	17:05
15:15	16:02	16:20	17:25
		16:40	17:45
15:45	16:32	17:00	18:05
16:15	17:02	17:20	18:25
		17:40	18:45
16:45	17:32	18:00	19:05
17:15	18:02	18:20	19:25
17:35	18:22	18:40	19:45
17:45	18:32	19:00	20:05
18:15	19:02	19:20	20:25
		20:00	21:05
19:15	20:02	20:20	21:25
		20:40	21:45
		21:00	22:05

*Highway Bus departures after 19:15 are not listed in this schedule.

*Airport Bus departures before 9:20 are not listed in this schedule.

Notes regarding transportation to Awaji Yumebutai from KIX:
 (Airport Bus) The 21:35 departure from Kansai Int'l Airport Terminal 1 is the latest airport bus that will arrive in time for the highway bus transfer.
 (Highway Bus) Before boarding the highway bus, please confirm that it will stop at 'Awaji Yumebutai' (or 'Kokudo Yumebutai' for departures after 19:00).

Notes regarding transportation to KIX from Awaji Yumebutai:
 (Highway Bus) Before boarding the highway bus, please confirm that it will stop at 'Sannomiya'.
 (Airport Bus) The 19:15 departure from Awaji Yumebutai is the latest highway

TAXI (one way): Kansai Int'l Airport to/from Awaji Yumebutai approx. 90 min., JPY 45,000-50,000.

Telephone number for Kansai Int'l Airport Information Center:

Highway bus boarding @Shin-Kobe (bus stop #1) and Sannomiya (bus stop #4) (To Awaji Yumebutai)

Take the bus is bound for **Higashi-Ura Bus Terminal**.

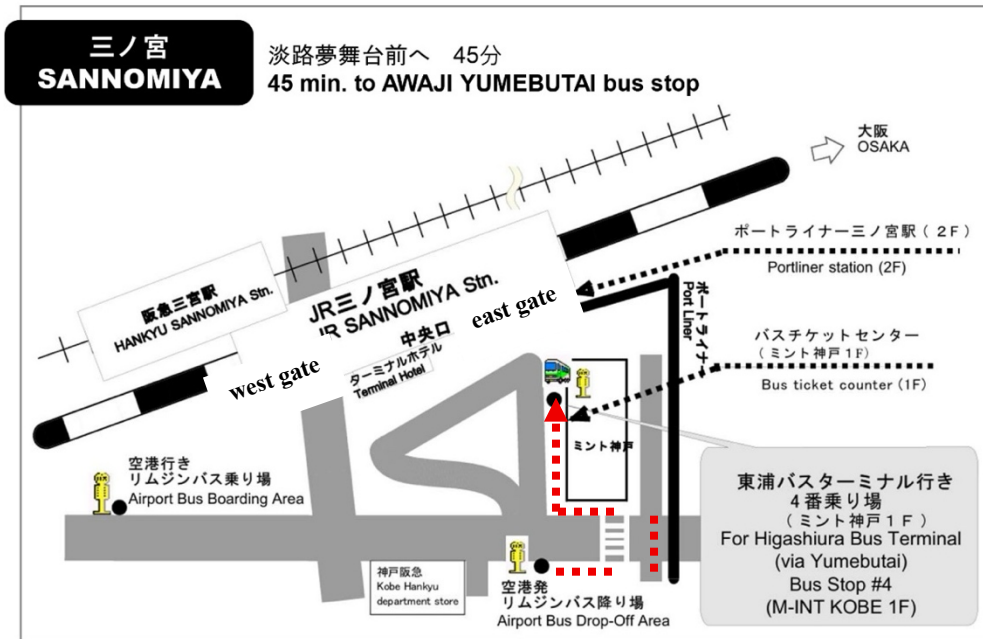
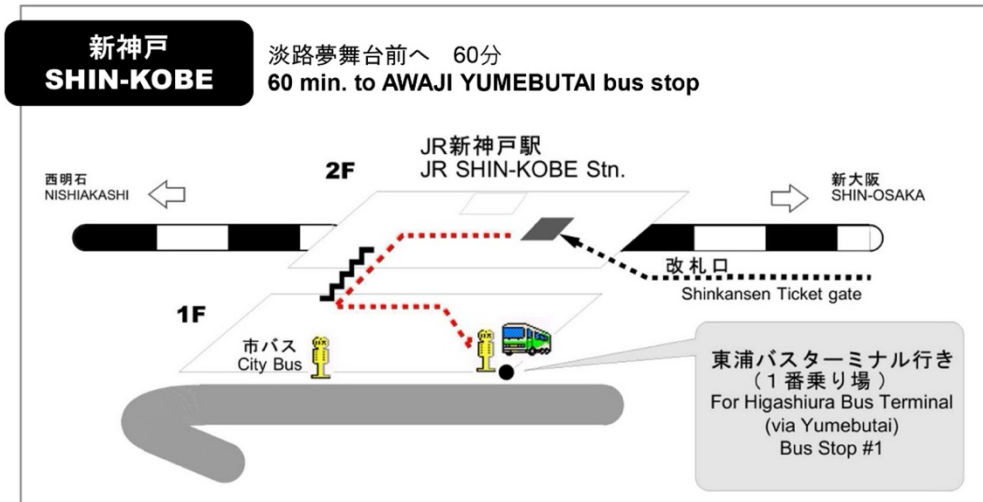

2

Buses arriving before 19:45 will go directly to Awaji Yumebutai, the bus stop in front of the Grand Nikko Awaji (your Hotel).

After 20:15, get off the bus at **Kokudo Yumebutai**. The bus stop is a 5 min-walk from the hotel, as instructed below.



① 国道夢舞台バス停(降車場所)
Kokudo Awaji Yumebutai bus stop
(Drop-off area)



② 歩道(左側:山 右側:海)
Sidewalk
(Left: mountains / Right: sea)



③ 横断歩道
Crosswalk



④ 歩道(夢舞台敷地内)
Sidewalk
(Yumebutai grounds)

※国道夢舞台バス停から淡路夢舞台国際会議場、
グランドニッコー淡路までは、
徒歩約5分です。

*Awaji Yumebutai International Conference Center &
Grand Nikko Awaji are about a 5-min. walk
from the Kokudo Yumebutai bus stop.*

Hotel map

The lobby (front) is located on the second floor. Please take the escalator to reach it.

The Grand Nikko Awaji 1F

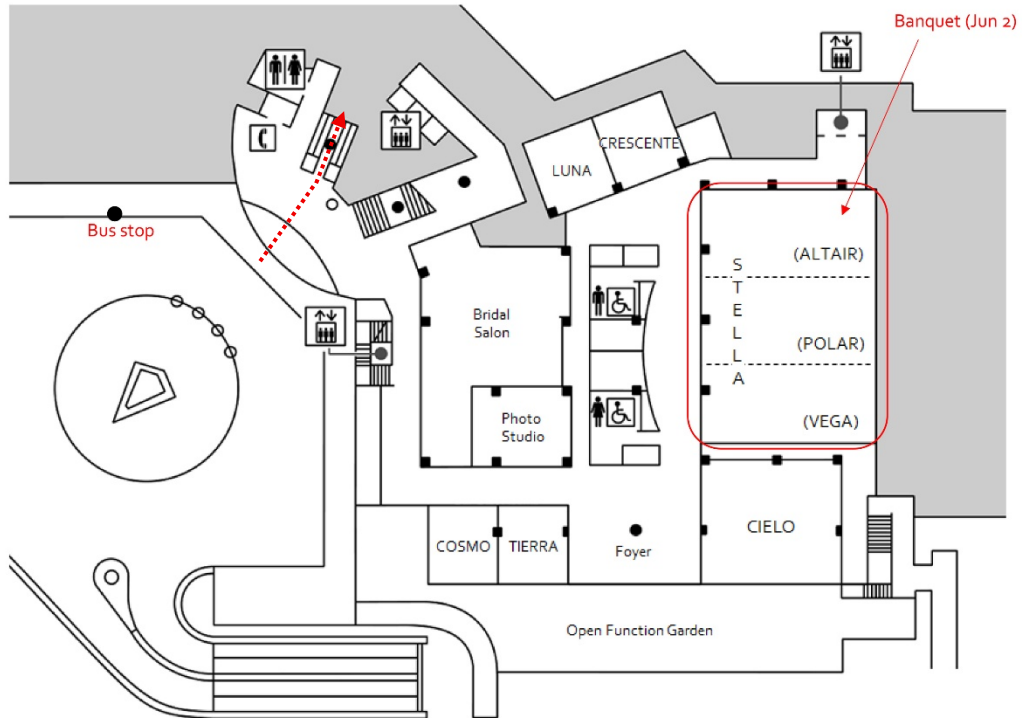

The Grand Nikko Awaji 2F

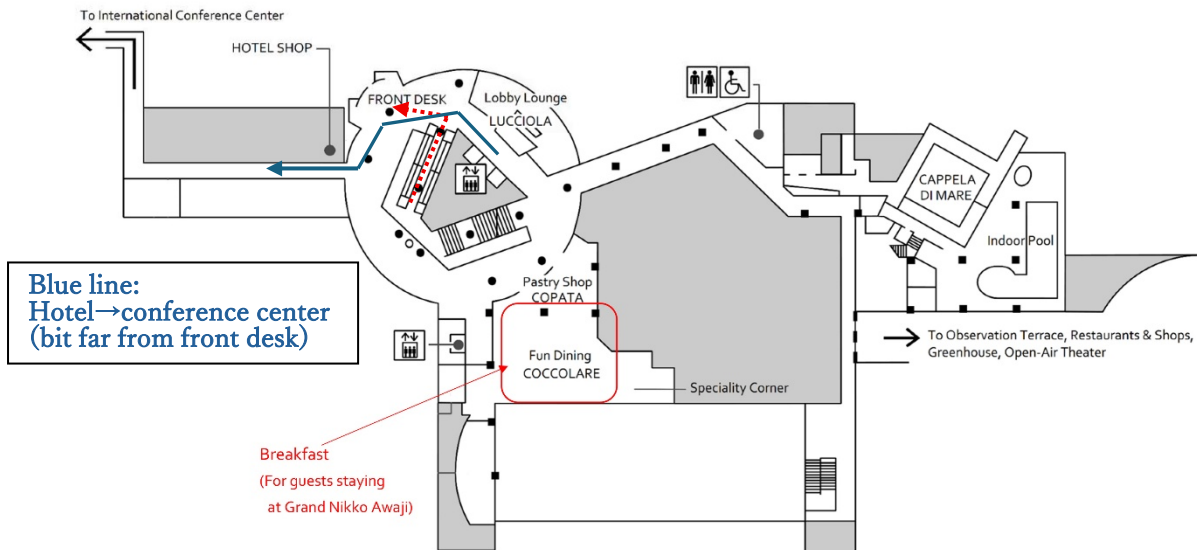

Conference center map

2 F

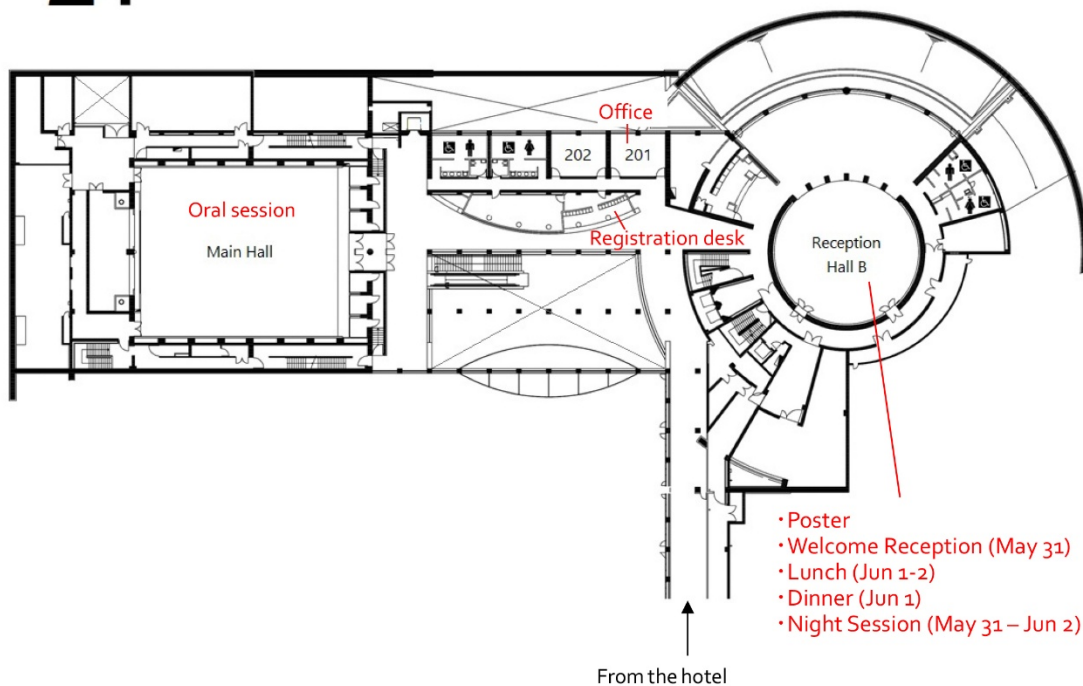

1 F

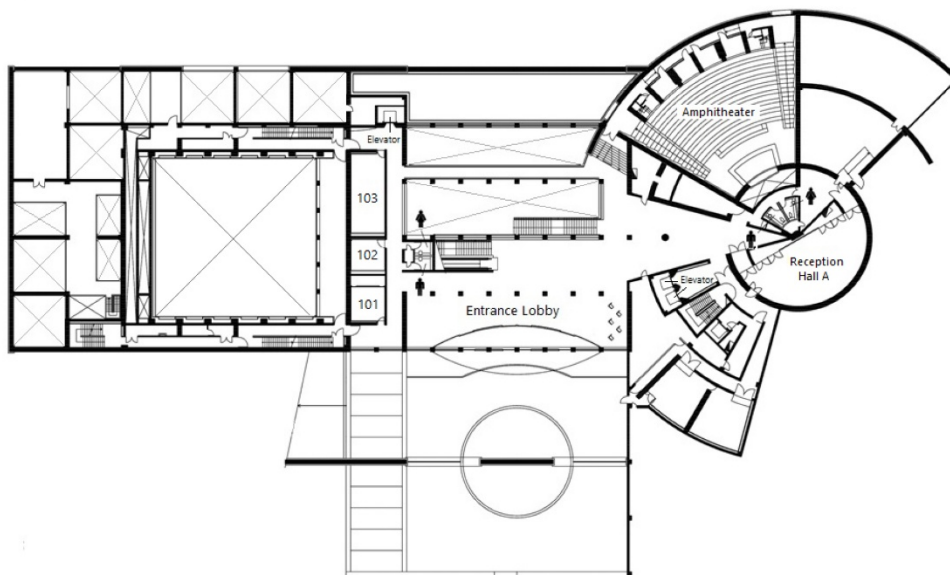

PROGRAM

Day 1 - 31 May 2026		
11:00-14:00	Registration	
14:00	Welcome and Introduction	The Organizers
Session 1: Chromosome Segregation		Chair: Sue Biggins
14:15-14:40	Epigenetic compartmentalization of human centromeres	Aaron Straight
14:45-15:10	Focusing in on centromeric chromatin	Ben Black
15:15-15:30	Mechanisms of size-dependent chromosome arrangement on the spindle	Kozo Tanaka
15:30-15:45	CCAN forms the spherical shell-like structure in interphase centromeres	Yuji Sakai
15:45-16:10	Coffee break	
16:15-16:40	Do nucleosomes hold the key to genomic stability?	Jon Pines
16:45-17:10	Molecular Determinants and Evolutionary Outcomes of Centromere-Targeted Transposition	Barbara Mellone
17:15-17:30	A Phosphorylation-encoded System of Mitotic Memory	Esther Feng Ying Ng
17:30-17:45	Organization of Centromere Architecture by SMC Complexes	Carlos Sacristan
17:45-18:00	Mitotic chromosome scaling in cleavage-stage mouse embryos	Marina Makharova
18:00	Dinner	
Keynote lecture		Chair: Tatsuo Fukagawa
20:00-21:00	Dis-solving the mechanisms of mitotic chromosome formation	Bill Earnshaw
21:00	Drinks	

Day 2 - 1 June 2026		
Session 2: Genome Stability		Chair: Ben Black
09:00-09:25	An electrostatic repulsion model of centromere organization	Daniel Gerlich
09:30-09:55	Structure and Dynamics of Rad51 filament during homology search in living cells	Angela Taddei
10:00-10:15	How are centromeres in human artificial chromosomes formed, and maintained across species?	Junichiro Ohzeki
10:15-10:30	Chromosomal instability drives adaptive convergence and tumor evolution	Minji Jo
10:30-11:00	Coffee break	
11:00-11:25	Mechanisms of extrachromosomal DNA inheritance and chromosomal reintegration	John Maciejowski
11:30-11:55	Single-stranded DNA damage induces i-loops and eccDNA from repetitive elements	Ylli Doksani
12:00-12:15	Replication Stress and DNA Damage shape centromere fragility	Annapaola Angrisani
12:15-12:30	Are different routes to induce whole genome duplication having different outcomes?	Simon Gemble
12:30-13:00	Highlighted posters session 1	The organizers
13:00-14:00	Lunch	Meet with Inke Nathke
14:00-16:00	Poster session 1	
Session 3: Aneuploidy and Cellular Response		Chair: Renata Basto
16:00-16:25	Control of kinetochores by spatially distinct Aurora A pools	Arshad Desai
16:30-16:55	Not too early, not too late - linking checkpoint silencing with mitotic memory to control accurate cell proliferation	Helder Maiato
17:00-17:15	Impact of whole-genome doubling on cancer cell behavior	Tomonori Matsumoto
17:15-17:30	Centrosomes as Error-Correction Machines	Marin Barisic
17:30-18:00	Coffee break	

18:00-18:25	A new role for Wee1 in controlling cell cycle entry	Alexis Barr
18:30-18:55	Consequences of Chromosome Segregation Errors on Cell Physiology	Stefano Santaguida
19:00	Dinner + Drinks	

Day 3 - 2 June 2026		
Session 4: Epigenetics Regulation		Chair: Alexis Barr
09:00-09:25	Mechanism of chromatin assembly during DNA replication	Francesca Mattioli
09:30-09:55	An atlas of eukaryotic centromere architecture reveals cyclical evolutionary dynamics	Ian Henderson
10:00-10:15	Chromosome-specific DNA methylation dynamics at human centromeres during germ cell epigenetic reprogramming	Liyang Shi
10:15-10:30	Genetic and epigenetic architecture of tandem repeats influences CENH3 re-establishment and drift in Arabidopsis	Sota Yamaguchi
10:30-11:00	Coffee break	
11:00-11:25	Mechanical and soft matter properties of the nucleus in genome integrity & function	Yekaterina Miroshnikova
11:30-11:55	Chromosome-end protection in stem cells	Jerome Dejardin
12:00-12:15	Genome-wide detection and characterization of de novo loss of heterozygosity events using single-cell haplotype-resolved sequencing	Dmitrii Olisov
12:15-12:30	Phase separation-driven repulsion ensures Aurora B centromere fidelity via epigenetic compartmentalization	Xuebiao Yao
12:30-13:00	Highlighted posters session 2	The organizers
13:00-14:00	Lunch	
14:00-16:00	Poster session 2	
Session 5: Structures Achieving Chromosome Segregation		Chair: Aaron Straight
16:00-16:25	Cnn1 strengthens kinetochore-microtubule attachments via Stu2	Sue Biggins
16:30-16:55	Balancing Act: Centromere Recruitment of Counteracting Enzymatic Activities	Jeyaprakash Arulanandam
17:00-17:15	Structural basis of the CPC interaction with Sgo1 and architecture of the ternary complex CPC-(Sgo1) ₂ -PP2A	Dario Segura-Peña

17:15-17:30	Structural and evolutionary insights into KNL2 variants involved in plant centromere function and kinetochore assembly	Inna Lermontova
17:30-18:00	Coffee break	
18:00-18:25	Structural features of nucleosomes in human chromosomes	Yasuhiro Arimura
18:30-18:55	How to exercise proper restraint when (not) segregating your chromosomes	Kyle W Muir
19:20	Gala Dinner	

Day 4 - 3 June 2026		
Session 6: Centrosome Biogenesis		Chair: Jon Pines
09:00-09:25	De novo centriole assembly in human cells[Daiju Kitagawa
09:30-09:55	A novel mechanism for centrosome expulsion ensures metabolic activity in polyploid cells	Renata Basto
10:00-10:15	Light-induced spindle assembly (LISA) through Aurora A clustering	Sachin Kotak
10:15-10:30	Ectopic KIFC1 accumulation at interphase centrosomes causes monopolar spindles by inhibiting centrosome separation in medaka early embryos	Takahiro Yamamoto
10:30-11:00	Coffee break	
11:00-11:25	Center of the microtubule universe: dissection and reconstitution of the building blocks of the centrosome	Anna Akhmanova
11:30-11:55	Spindle pole proteins are repurposed as chromosome glue during female meiosis	Jeff Woodruff
12:00-12:30	Closing remarks	The organizers
Departure		